

# Ofune Site Audio Guide

## How to use

- ① Borrow audio devices from our staff.
- ② At the numbered locations on the map, play the same number of audio on the audio device.

The Guidance Voice is readed by  
"Ondoku san"  
(automated voice)



- ① Office
- ② Information
- ③ Jomon Village:  
Reconstructions of Pit  
Dwellings (Frame)
- ④ Reconstructed Pit
- ⑤ Fully-Reconstructed  
Dwelling
- ⑥ Flat display
- ⑦ Reconstructed Pit 2
- ⑧ Earthwork Mound
- ⑨ View to the Pacific  
Ocean
- ⑩ Jomon Forest

For inquiries: Japanese only  
**Hakodate Jomon Culture Center**  
(+81)138-25-2030

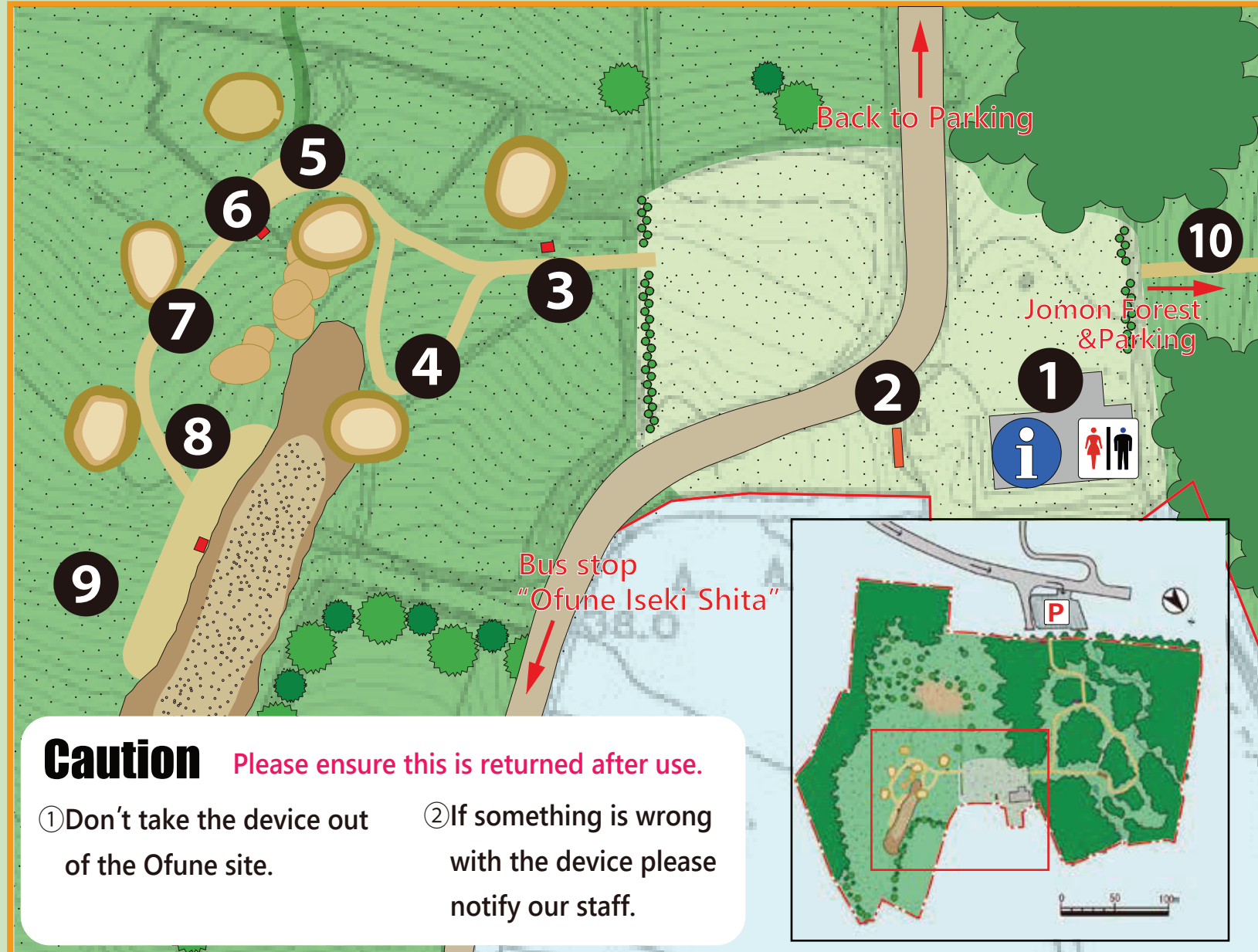

## Caution

Please ensure this is returned after use.

- ① Don't take the device out of the Ofune site.
- ② If something is wrong with the device please notify our staff.